

LUMINIS®



INLINE
TURN MORE HEADS



THE MODERN FAMILY

Clean, elegant and contemporary, the inline family displays its own distinctly urban edge.

The Inline bollards and columns provide impactful illumination for spaces such as parks, plazas, outdoor patios, landscaped gardens and other urban environments. Independently adjustable light modules ensure designers have the freedom to capture what's important in a given landscape arrangement.

MAKING ITS OWN STATEMENT

Inline is a discreet, sophisticated luminaire with outstanding performance and functionality. The family of columns and bollards makes an architectural statement, elevating exterior spaces to interior design standards.



REFINE SPACE

Inline bollards establish the tone of outdoor spaces: contemporary and versatile. In a range of heights and with up to two light modules per bollard, they respond precisely to landscape lighting needs. Inline bollards deliver up to 4,191 lumens per module, suitable for a variety of spaces such as parks, staircases and pathways.

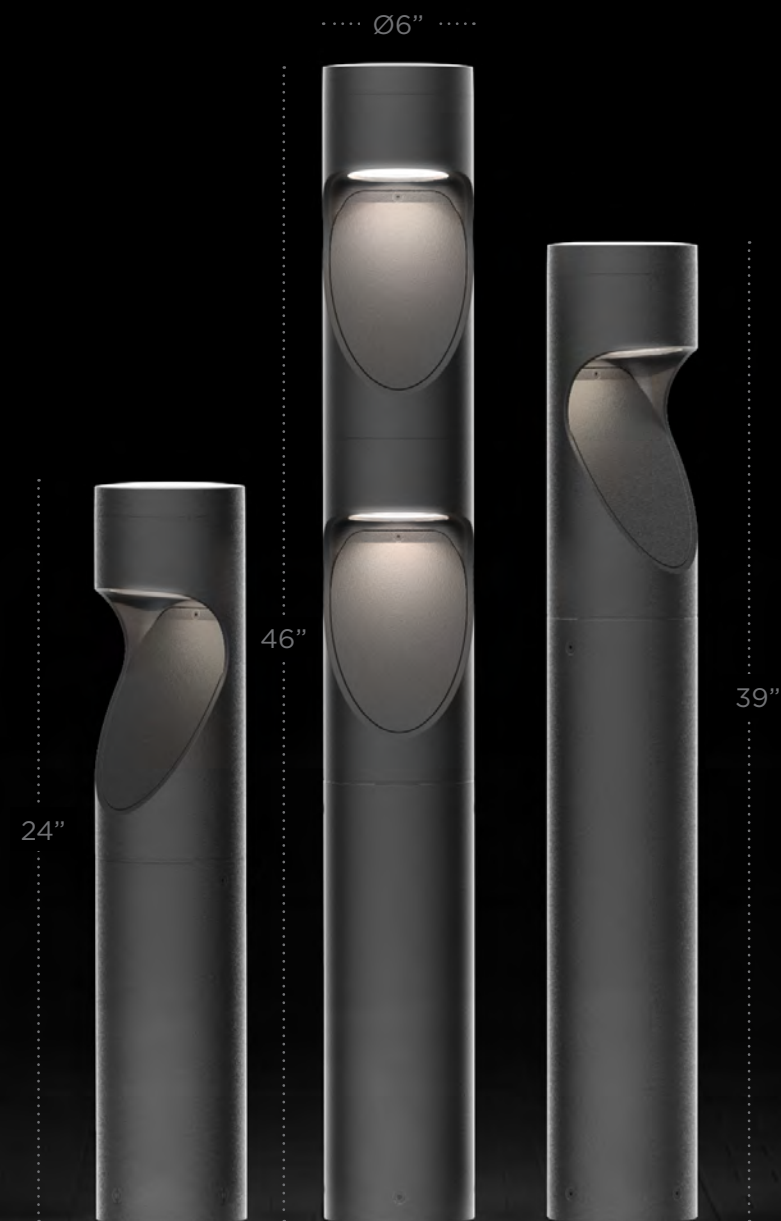



POWER PLAY

The Inline columns bring an architectural aesthetic to any surrounding including plazas, outdoor arena spaces, and pedestrian areas. Available with up to 4 modules per column, 4,809 lumens per module, and up to 20' in pole height, they are true performers that make a distinctive design statement.

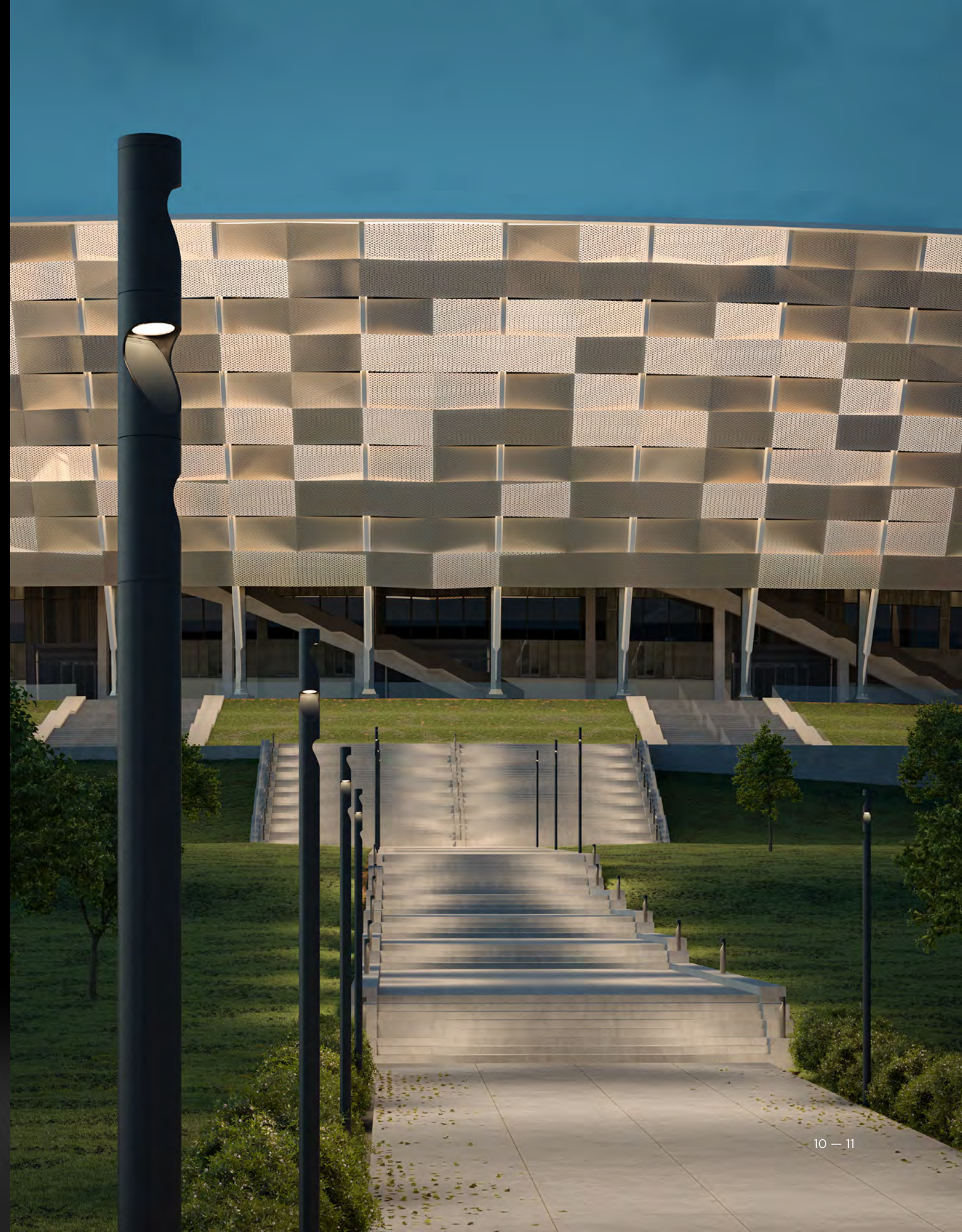
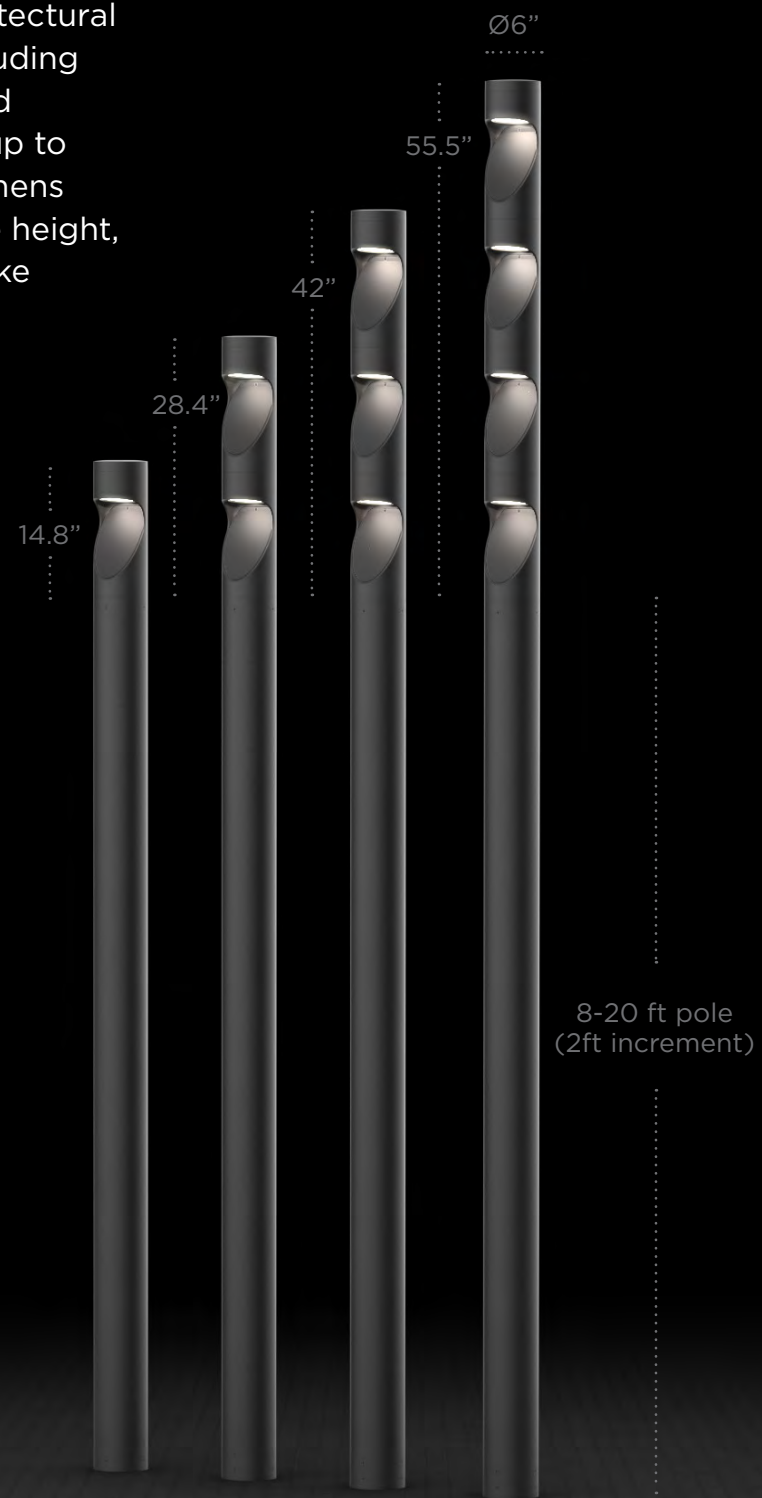

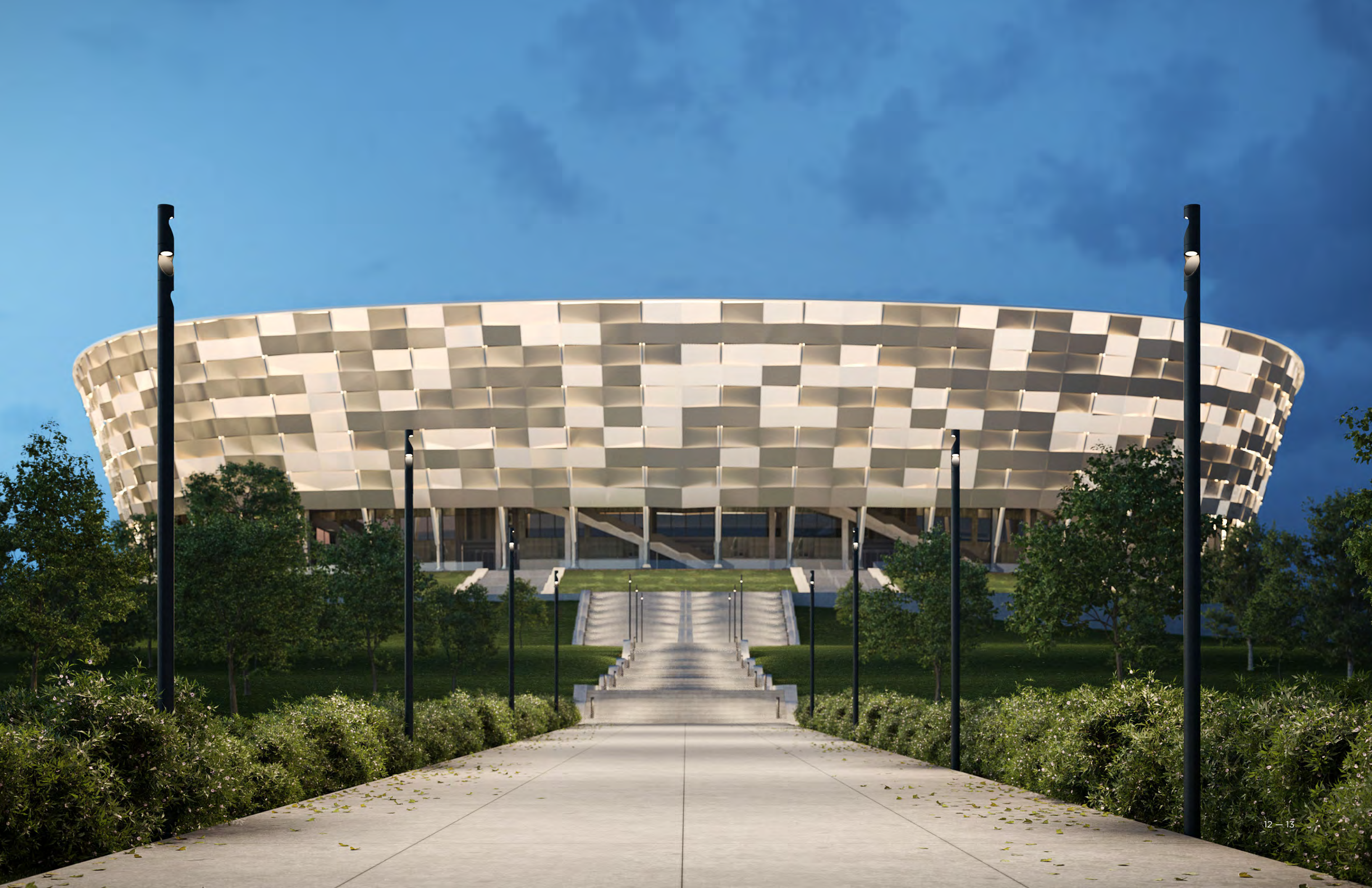

READY. AIM. ILLUMINATE.

Inline's light modules rotate 355 degrees individually for controlled illumination and one-of-a-kind lighting flexibility. Its signature curved sculpted opening and deeply recessed lens directs light beams downward to minimize uplight while enhancing comfort and glare control.

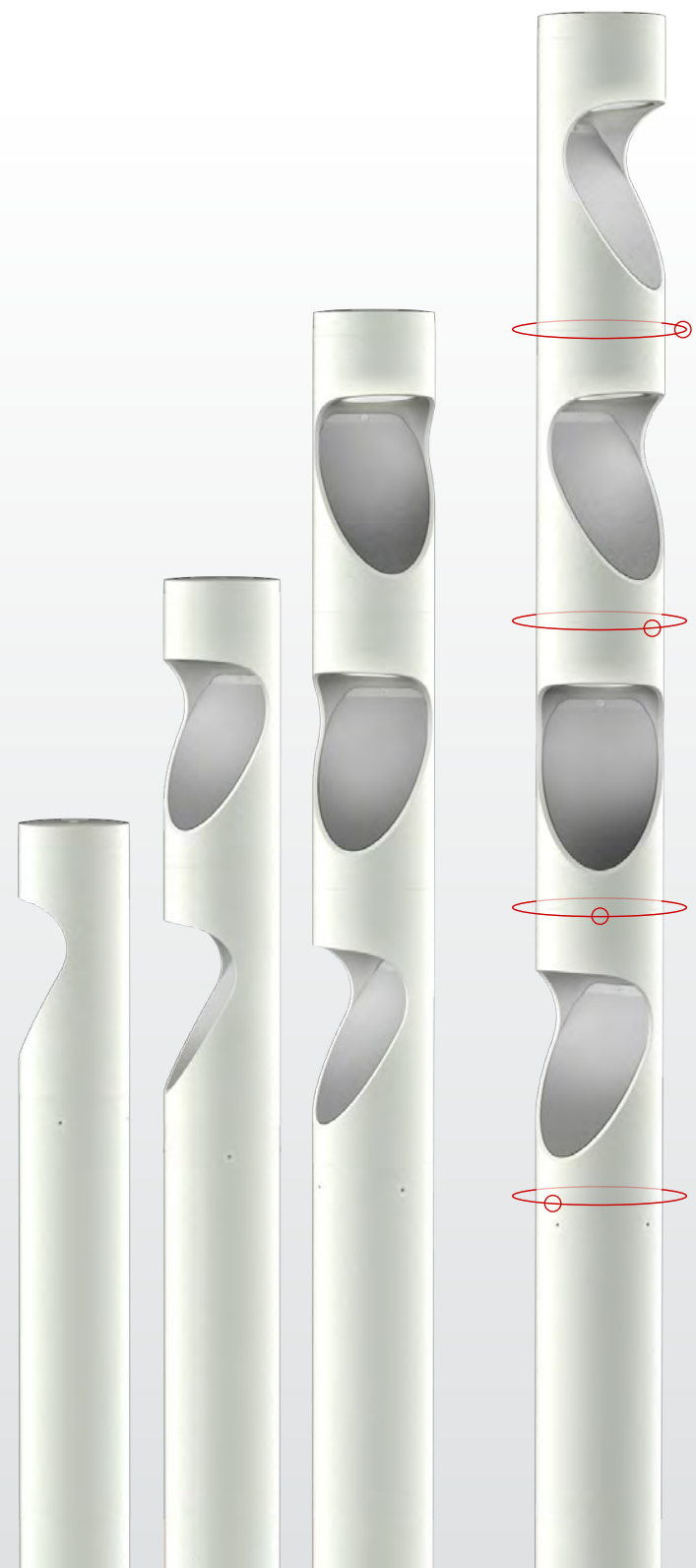

Final positioning and rotation of each light module can be modified on-site during installation.



LIGHTING SHAPED BY IMAGINATION

The magic of Inline lies in its modularity. Designers can create endless patterns of illumination by choosing the best combination for an exterior space.

SINGLE HEAD BOLLARD
Straight path

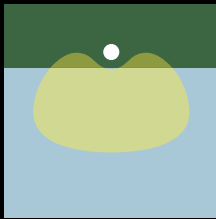

DUAL HEAD BOLLARD
Corner path

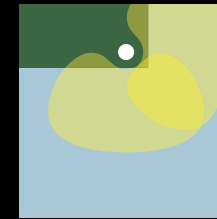

TRIPLE HEAD COLUMN
U-Shape path

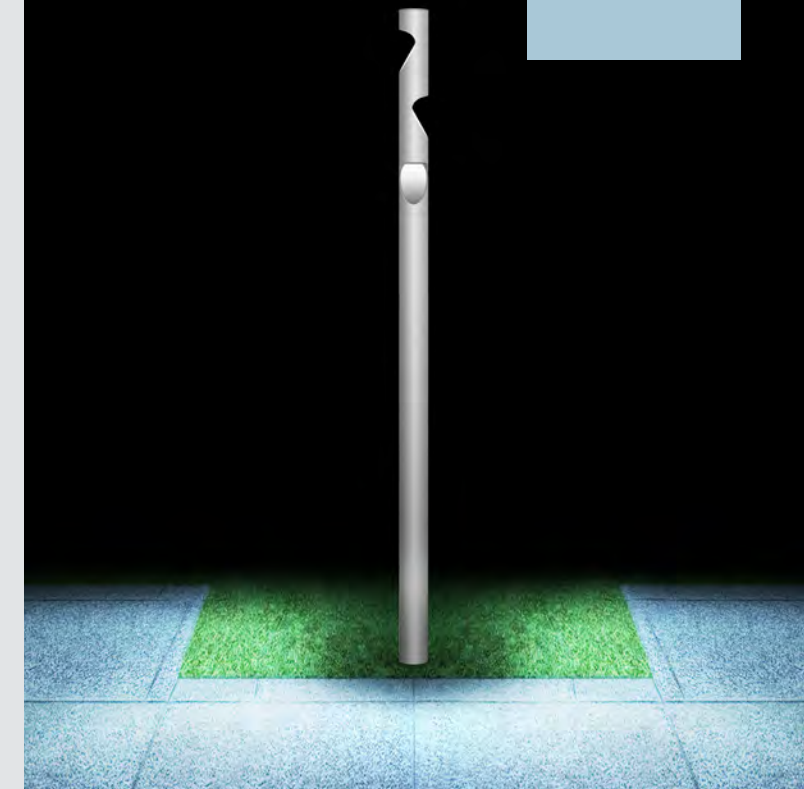
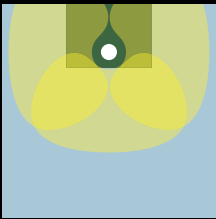

SINGLE HEAD COLUMN
Straight path

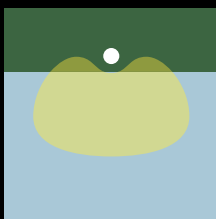

DUAL HEAD COLUMN
Corner path

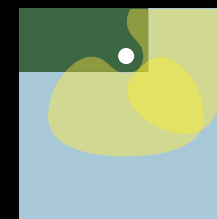

QUADRUPLE HEAD COLUMN
Round path

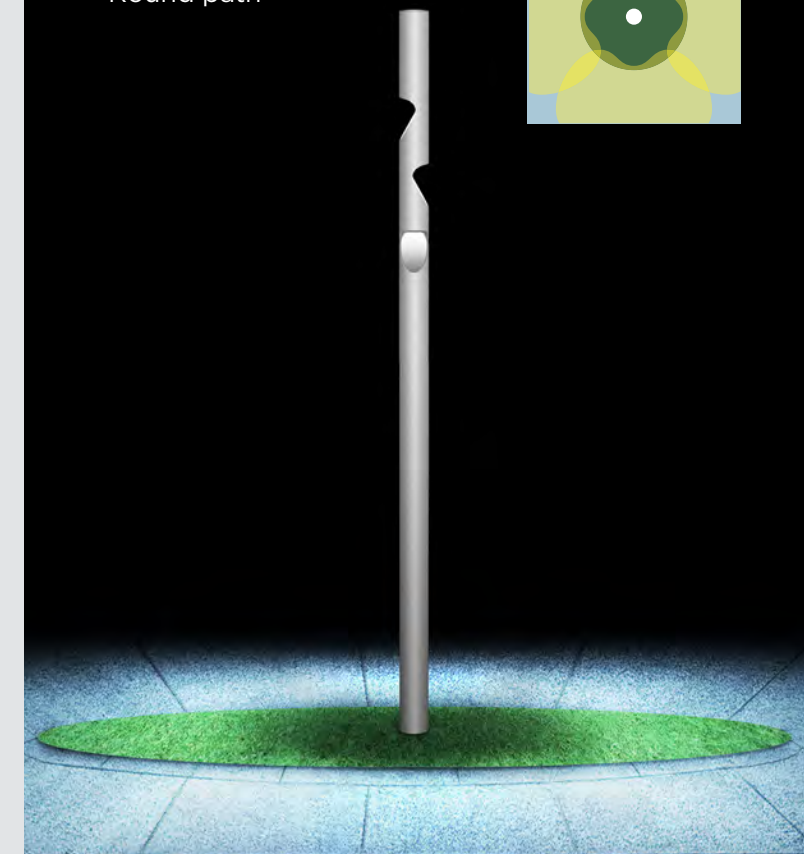
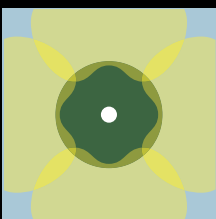

SELECT. STACK. TURN.

The Inline family gives designers countless options and design freedom to choose the best combination for a space. Let's count the ways:

FEATURES

- Independent light module rotation up to 355°
- Offered with 15°, 30° and 55° beam angle reflectors
- Type III distribution available
- Columns: Available with up to 4 modules per column, 4,809 lumens per module, and up to 20' in pole height
- Bollards: Available with up to 2 modules per bollard, 4,191 lumens per module, 3 standard heights: (24", 39" and 46")

OPTIONS

- Standard LED modules offering in 2700K, 3000K, 3500K, 4000K at 80CRI
- True amber LED
- 120V, 277V, 347V and 480V
- nLight® air 
- Faux wood finish
- Photocell, motion sensor, GFI
- Remote emergency battery backup (bollard only)

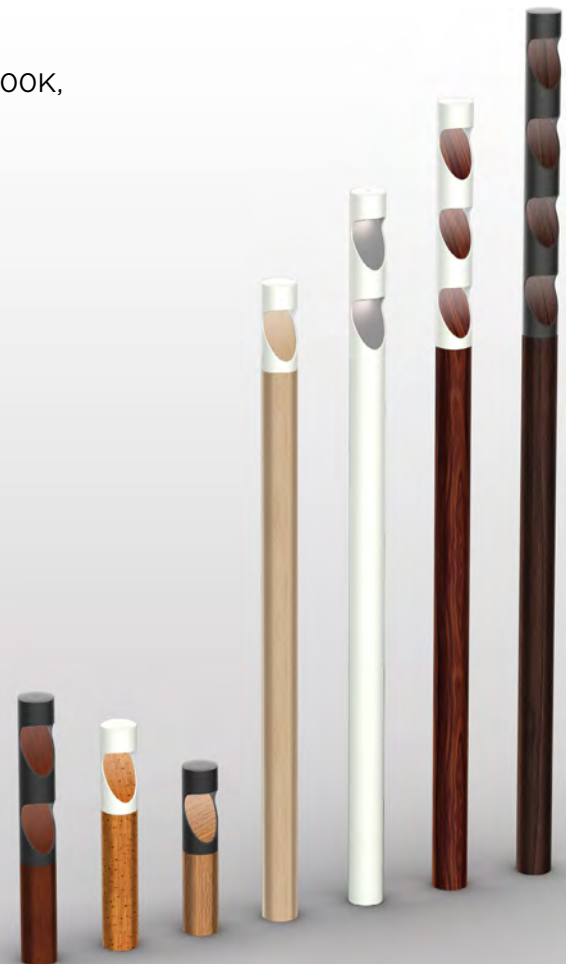

STANDARD FINISHES

With our in-house powder coating experience, we offer numerous standard finishes and can color match custom colors allowing your vision to come to life.

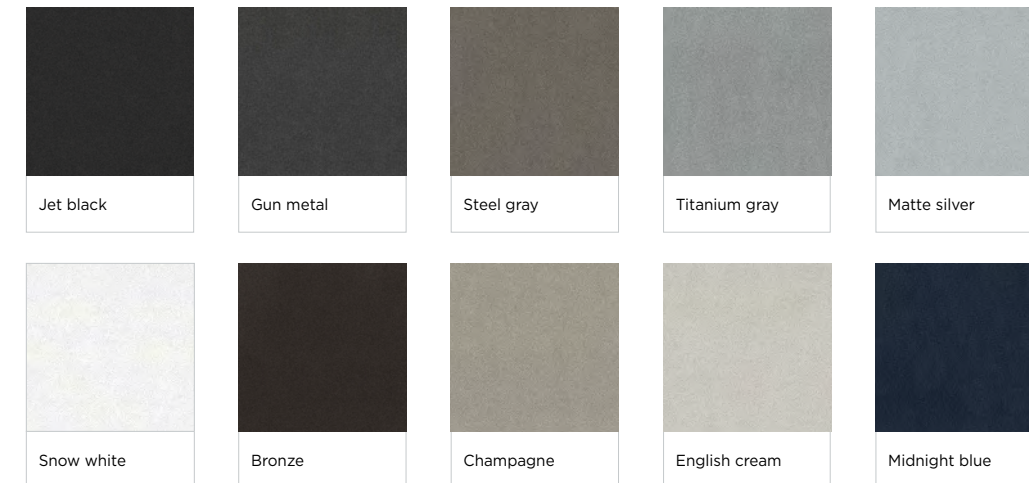

FAUX WOOD FINISHES

Our faux wood finishes capture the warmth of real wood and bring unique flare to exterior lighting designs. Actual wood grain patterns complete with knots add convincing texture.

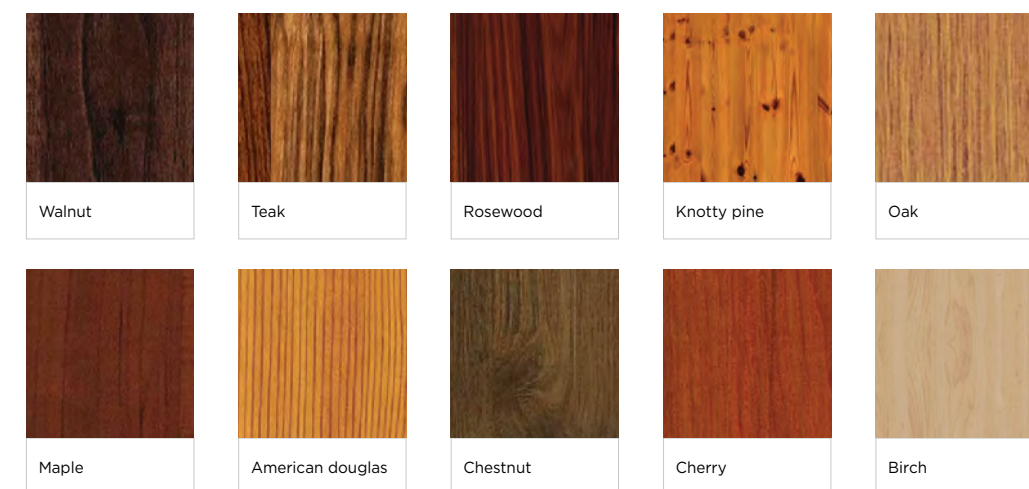



MARCH 2023 — Luminis is a registered trademark.

INLINE

260 Labrosse, Pointe Claire
QC H9R 5L5

514-683-3883
1-866-586-4647

info@luminis.com

LUMINIS.COM

 **AcuityBrands.**